

Cambridge Case Study

Distribution Center

Dallas/Ft. Worth, TX



BUILDING DETAILS

Size: 604,800 sq.ft. x 35 ft. High
Construction: R-2.7 Roof
 R-1.5 Walls

OPERATING CONDITIONS

Operating Hours: 24 hrs/day 5 days/wk
Design Temperature: 60° @ 10°
Thermostat settings: On @ 64° / Off @ 70°
Average Temperature: 70°
Heating System: Cambridge Space Heaters
 4 @ 1900 MBH
 4 @ 2279 MBH
 Roof top mounting

CALCULATED OPERATING COSTS *

for 30 year (1971-2000) average heating seasons

Indoor Temp	HDDs	@ \$0.75 / therm	@ \$1.00 / therm	@ \$1.25 / therm
50°	672	\$0.01 / ft ²	\$0.01 / ft ²	\$0.01 / ft ²
55°	1,114	\$0.01 / ft ²	\$0.02 / ft ²	\$0.02 / ft ²
60°	1,713	\$0.02 / ft ²	\$0.02 / ft ²	\$0.03 / ft ²
65°	2,470	\$0.03 / ft ²	\$0.03 / ft ²	\$0.04 / ft ²

* based on actual 1998-99 consumption of 23,950 therms for 2,816 Heating Degree Days

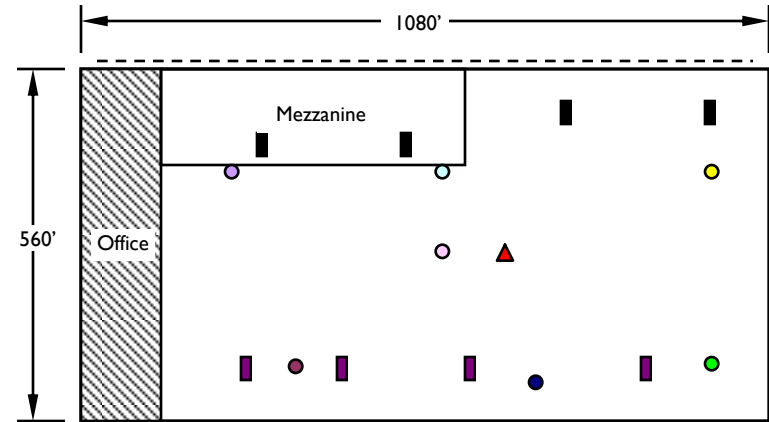

- Temperature Logger @ 8' AFF
- ▲ Temperature Logger @ 30' AFF
- 1900 MBH Heater
- 2279 MBH Heater

DATALOGGER GRAPH

Logging period: 12/17/98 - 2/9/99

Logging interval: 30 minutes

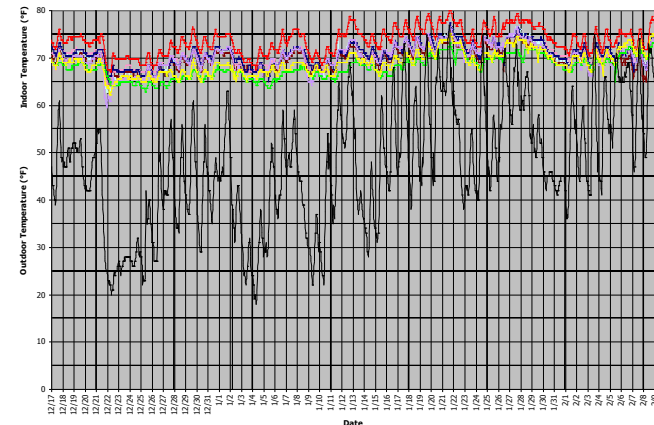

760 Long Road Crossing Dr. • Chesterfield MO 63005
 800-899-1989 • www.cambridge-eng.com